

Easypump[®] ST/LT Disposable Infusion System

Important notes

Bring the Easypump ST/LT (short-term/long-term) device to room temperature prior to use.

- Allow the device to reach room temperature for 6 to 12 hours before your infusion. Solution that's colder than the room temperature may take longer to infuse.
- To help you remember, remove the next dose from the refrigerator just before starting your infusion. If your dose is less than every 6 to 8 hours, you can remove two doses at a time from the refrigerator.
- **DO NOT HEAT** the Easypump ST/LT device using a heat source such as microwave oven, direct sunlight or hot water. Heating may affect how the device works and how fast the medication is infused (also known as the infusion rate).

Preparation

Please refer to your SASH (Saline, Administration, Saline, Heparin) Teaching Mat for more details.

1. **Clean** your work area.
2. **Wash** your hands.
3. **Gather** your supplies:
 - Easypump ST/LT device, at room temperature
 - Alcohol pads
 - Saline flushes — Two pre-filled saline syringes
 - One pre-filled heparin syringe (if ordered)
 - Trash container
4. **Inspect** the medication label:
 - Correct patient name
 - Correct medication and dose
 - Medication is not expired
 - Length of infusion
 - The solution should be clear, consistent in color and free of any visible particles

Flush Your Catheter

Please refer to your SASH Teaching Mat for more details.

Priming Your Tubing

1. Your Easypump ST/LT is prefilled with your medication. The tubing on the pump must be filled with the medication prior to starting the infusion. Remove the cap from the end of the tubing. Do not let the end of the tubing touch anything.

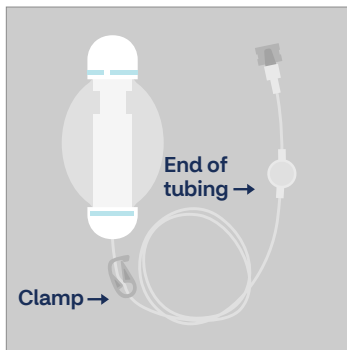

2. Open the clamp on the tubing. While holding the filter upright allow the medication to fill the tubing slowly. When a drop of medication is at the end of the tubing close the clamp.

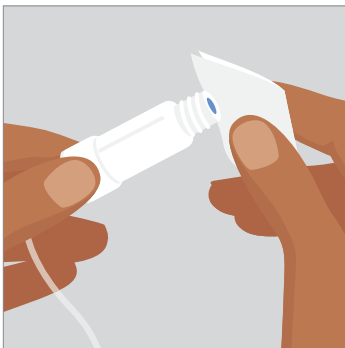

3. Continue to hold the end of the tubing after priming. Be careful not to let the end of the tubing touch anything while you prepare to attach it to your catheter.
4. Open the clamp on the tubing to allow the medication to infuse. While the medication is infusing, put the Easypump device in a pocket, on a nearby surface or in a pouch. Do not use while bathing, showering or swimming.

5. The medication should infuse over _____ minutes/hours. Your Coram® CVS Specialty® Infusion Services (Coram) pharmacist or nurse will also tell you how long the infusion should last. There are no alarms to alert when the medication is done infusing. Check the Easypump device to see that it's getting smaller. That means you are getting your medication. When the Easypump device is flat, you've received all your medication.
6. When the infusion is done, close the clamp on the tubing.
7. Disconnect the tubing from the catheter injection cap. Throw away the whole Easypump. Follow any other instructions the nurse has provided.

Flush Your Catheter

Please refer to your SASH Teaching Mat for more details.

Troubleshooting

If the pump doesn't seem to be working, make sure:

- The pump is at room temperature
- The clamp on the tubing is open (moves freely on the tubing)
- All clamps on your catheter are open
- There are no kinks in the pump tubing

Follow your nurse's instructions to make sure that your catheter is working well.

Resource: Easypump® ST/LT Elastomeric Infusion Pump System: Patient Guide. B. Braun Medical Inc. <https://www.bbraunusa.com/en/products/b4/easypump-st-lt.html>.

This information is not a substitute for medical advice or treatment. Talk to your doctor or health care provider about this information and any health related questions you have. Coram assumes no liability whatsoever for the information provided or for any diagnosis or treatment made as a result of this information.

Your privacy is important to us. Our employees are trained regarding the appropriate way to handle your private health information.

©2024 CVS Health and/or one of its affiliates.
All rights reserved. 75-51712B 082424 ®